





ALL-BLACK CS6K-280 | 285MS-SD

Canadian Solar's ALL-BLACK SmartDC module features an innovative integration of Canadian Solar's new superpower module technology and SolarEdge's power optimization for grid-tied PV applications.

By replacing the traditional junction-box with a power optimizer, the SmartDC module optimizes power output at module-level. With this feature, the SmartDC module can eliminate module-level mismatch and decrease shading losses. Furthermore, the SmartDC module provides module-level monitoring that allows effective system management and minimizes operational costs.



KEY FEATURES

- 
Harvests up to 25% more energy from each module
 - Maximizes power from each individual module against potential mismatch risk
 - Decreases shading losses
- 
Easy installation, simple system design
 - Integrated smart solution, no need to add other accessories
 - Enhances the shading tolerance
- 
Reduces BoS Costs
 - Up to 11.25 kW ~ 12.75 kW per string allows for more modules to be based on different inverters
- 
Free module-level monitoring system
 - Full visibility of system performance with a free smartphone app
- 
Safety
 - Automatic drop of DC current and voltage when inverter or grid power is shut down

25 years linear power output warranty

10 years product warranty on materials and workmanship

MANAGEMENT SYSTEM CERTIFICATES*

ISO 9001:2008 / Quality management system
 ISO/TS 16949:2009 / The automotive industry quality management system
 ISO 14001:2004 / Standards for environmental management system
 OHSAS 18001:2007 / International standards for occupational health & safety

PRODUCT CERTIFICATES*

IEC 61215 / IEC 61730: VDE/CE
 UL 1703: CSA



*As there are different certification requirements in different markets, please contact your Canadian Solar sales representative for the specific certificates applicable to the products.

CANADIAN SOLAR INC. is committed to providing high quality solar products, solar system solutions and services to customers around the world. As a leading manufacturer of solar modules and PV project developer with about 12 GW of premium quality modules deployed around the world since 2001, Canadian Solar Inc. (NASDAQ: CSIQ) is one of the most bankable solar companies worldwide.

CANADIAN SOLAR (USA) INC.

2420 Camino Ramon, 125 Suite San Ramon, CA, USA 94583-4385, www.canadiansolar.com, sales.us@canadiansolar.com

ENGINEERING DRAWING (mm)

Rear View

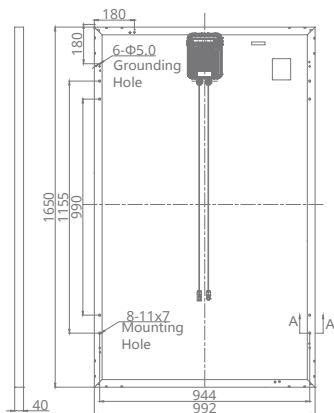

Frame Cross Section A-A

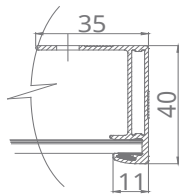

Mounting Hole

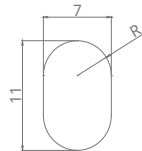

CS6K-285MS-SD / I-V CURVES

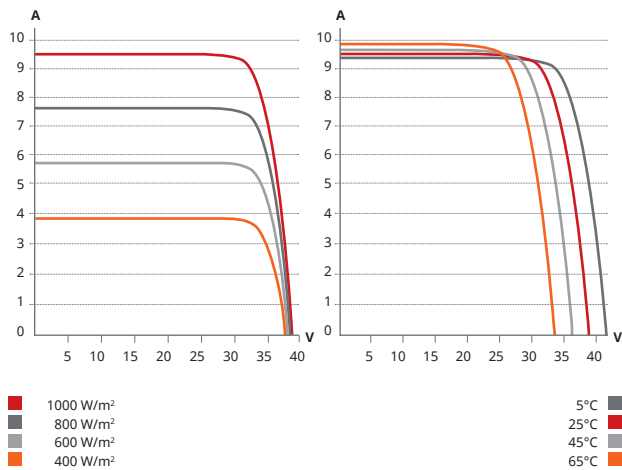

ELECTRICAL DATA / STC

Power Optimizer connected to a SolarEdge Inverter

CS6K	280MS-SD	285MS-SD
Nom. Max. PWR (Pmax STC)	280 W	285 W
Nom. Max. PWR (Pmax NOCT)	204 W	207 W
Open Circuit Voltage (Voc STC)	38.9 V	39.1 V
Output Voltage Range (Vout)	5-60V	5-60V
Max. Output Current (Imax)	15 A	15 A
Max. Series Fuse Rating	20 A	20 A
Module Efficiency	17.11 %	17.41 %
Output During Standby (power optimizer disconnected from inverter or inverter off)	1 V	

MECHANICAL DATA OF PV MODULE

Specification	Data
Cell Type	Mono-crystalline, 6 inch
Cell Arrangement	60 (6×10)
Dimensions	1650×992×40 mm (65.0×39.1×1.57 in)
Weight	19.3 kg (42.5 lbs)
Front Cover	3.2 mm tempered glass
Frame Material	Anodized aluminium alloy
J-Box	IP65
Cable	PV1-F 1*6.0 mm² / 952 mm
Connectors	MC4
Standard	26 pieces, 548 kg (1208 lbs)
Packaging	(quantity & weight per pallet)
Module Pieces per Container	728 pieces (40' HQ)

PV SYSTEM DESIGN

Min. String Length	EU & APAC	1 ph	8	
		3 ph	16	
		3 ph - MV	18	
	US & Canada	1 ph	8	
		3 ph (208 V)	10	
Max. String Length	EU & APAC	1 ph	18	18
		3 ph	40	39
		3 ph - MV	45	44
	US & Canada	1 ph	18	18
		3 ph (208 V)	21	21
Max. Power per String (W)	EU & APAC	1 ph	5250	
		3 ph	11250	
		3 ph - MV	12750	
	US & Canada	1 ph	5250	
		3 ph (208 V)	6000	
Parallel Strings of Diff. Lengths	Yes			
Parallel Strings of Diff. Orientations	Yes			
Operating Temperature	-40°C ~ +85°C			
Max. System Voltage	1000 V (IEC) / 600 V (UL)			
Application Classification	Class A			
Fire Rating	Type 1 (UL1703) / Class C (IEC61730)			
Power Tolerance	0 ~ +5 W			

TEMPERATURE CHARACTERISTICS

Specification	Data
Temperature Coefficient (Pmax)	-0.41% / °C
Temperature Coefficient (Voc)	-0.31% / °C
Temperature Coefficient (Isc)	0.053 % / °C
Nominal Operating Cell Temperature	45±2°C

STANDARD COMPLIANCE

Specification	Standard
EMC	FCC Part15 Class B, IEC61000-6-2, IEC61000-6-3
PV Module	IEC61215, IEC61730, UL1703, CEC listing
PV Optimizer J-Box	EN50548, UL3730, IEC2109-1 (class II safety), UL1741
Fire Safety	VDE-AR-E 2100-712:2013-05

PARTNER SECTION

